

94

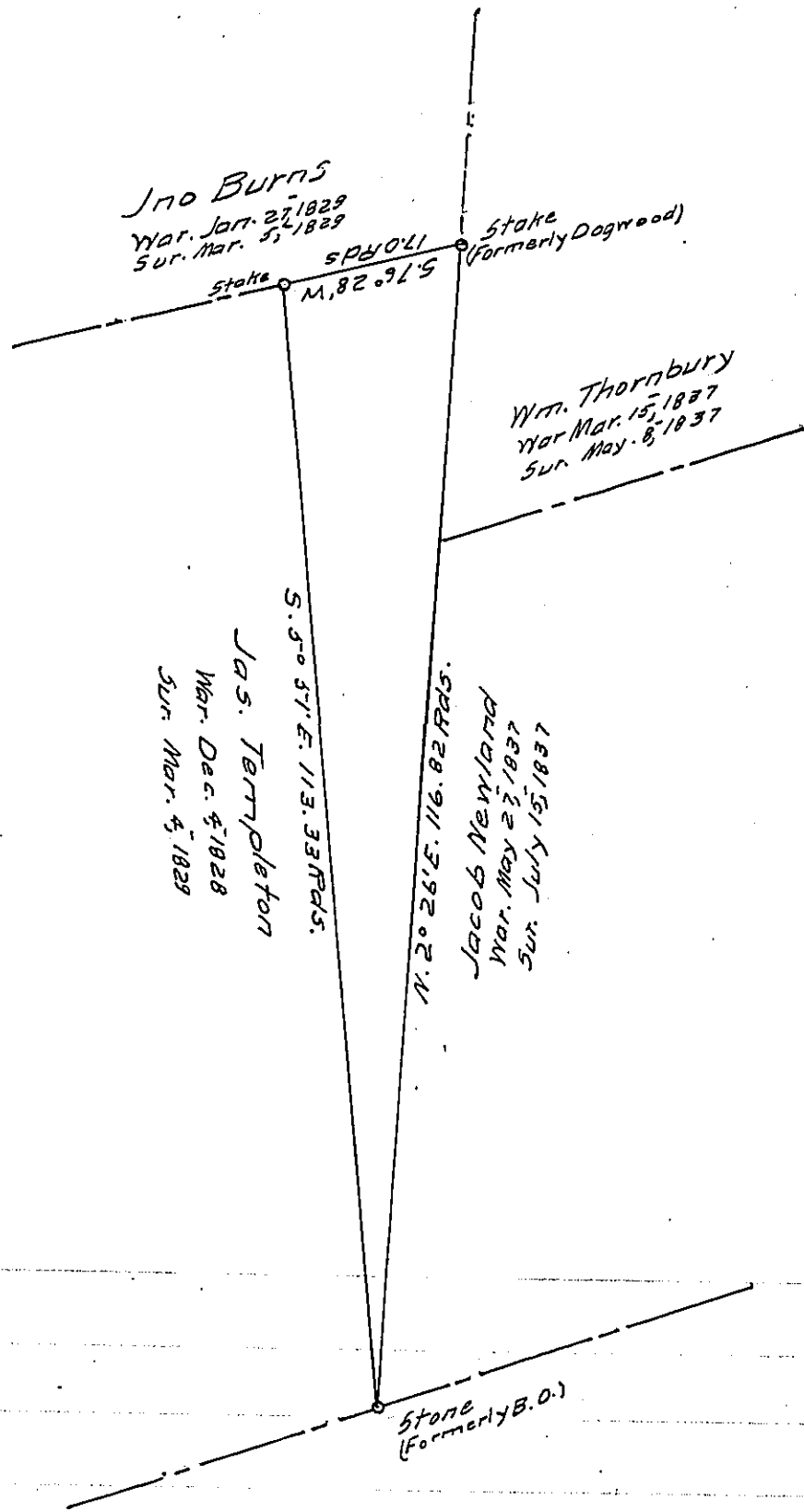

A Draught of a tract of land situated in the Township of West Finley and County of Washington, containing 5 acres, 100.14 perches and allowance of six per cent for roads, etc. Surveyed the 23<sup>rd</sup> day of May 1914, in pursuance of a warrant granted to L. F., J. A., & W. A. Miller dated the 10<sup>th</sup> day of Mar. 1914.

To Hon. Henry Houch,

Secretary of Internal Affairs.

Geo. S. Chaney

County Surveyor.

IN TESTIMONY that the above is a copy of the original remaining on file in the Department of Internal Affairs of Pennsylvania, made conformably to an Act of Assembly approved the 16th day of February, 1833, I have hereunto set my Hand and caused the Seal of said Department to be affixed at Harrisburg, this third day of February 1916.

*Henry Houch*  
 Secretary of Internal Affairs.